

TECHNICAL NOTE

CARRYOVER VOLUME CONFIGURATIONS



STANDARD CARRYOVER VOLUME

Competitors

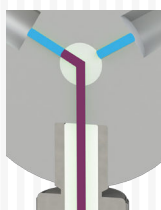

Carryover volume up to **50 uL**.

LOW CARRYOVER VOLUME

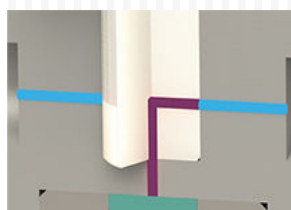
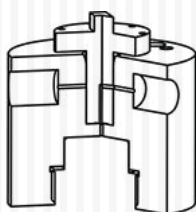

Syringe attachment modified to minimise the distance from the plug to the syringe. Carryover volume of **2.47 uL**.

ULTRA-LOW CARRYOVER VOLUME

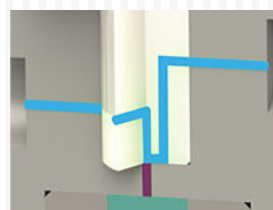
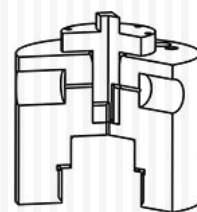

Valve design altered (two channels in the plug) to minimise the carryover volume inside the plug. Carryover volume of **1.4 uL**.

WHAT ARE WE DOING?

The carryover volume is defined as the volume of liquid that will be mixed with the next liquid. It is not stuck, but will be swept next time a liquid passes.

We developed a special configuration to minimise the carryover volume in our syringe pumps, for specific applications that require close to no contamination.

WHAT'S IN IT FOR YOU?

- Limited contamination
- Multiple liquids
- Automation
- Small reagent quantities

CONTACT US FOR MORE INFORMATION

Advanced Microfluidics SA
Ch. de la Dent d'Oche 1a
CH-1024 Ecublens
Switzerland

www.amf.ch
info@amf.ch
+41 21 552 14 30